

Planning Application 16/00822/FUL

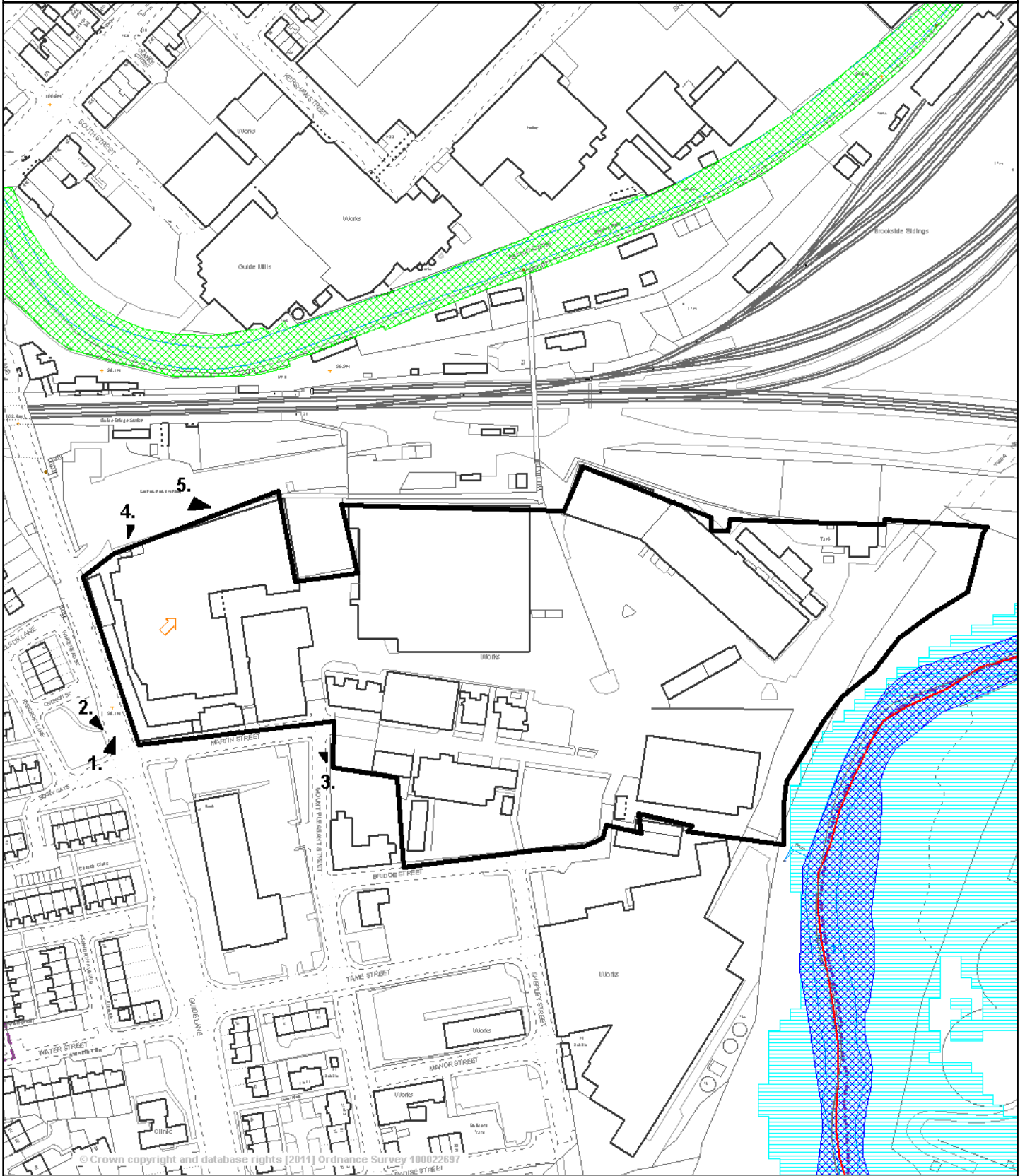

© Crown copyright and database rights [2011] Ordnance Survey 100022637

This map is reproduced from Ordnance Survey material with the permission of Ordnance Survey on behalf of the Controller of Her Majesty's Stationary Office (c) Crown copyright. Unauthorised reproduction infringes Crown copyright and may lead to prosecution or civil proceedings.

Scale 1/2500 Date 6/12/2016

Centre = 392744 E 397457 N

Application Number: 16/00822/FUL

Photo 1



Photo 2



Photo 3



Photo 4



Photo 5



Mono Pumps, Audenshaw

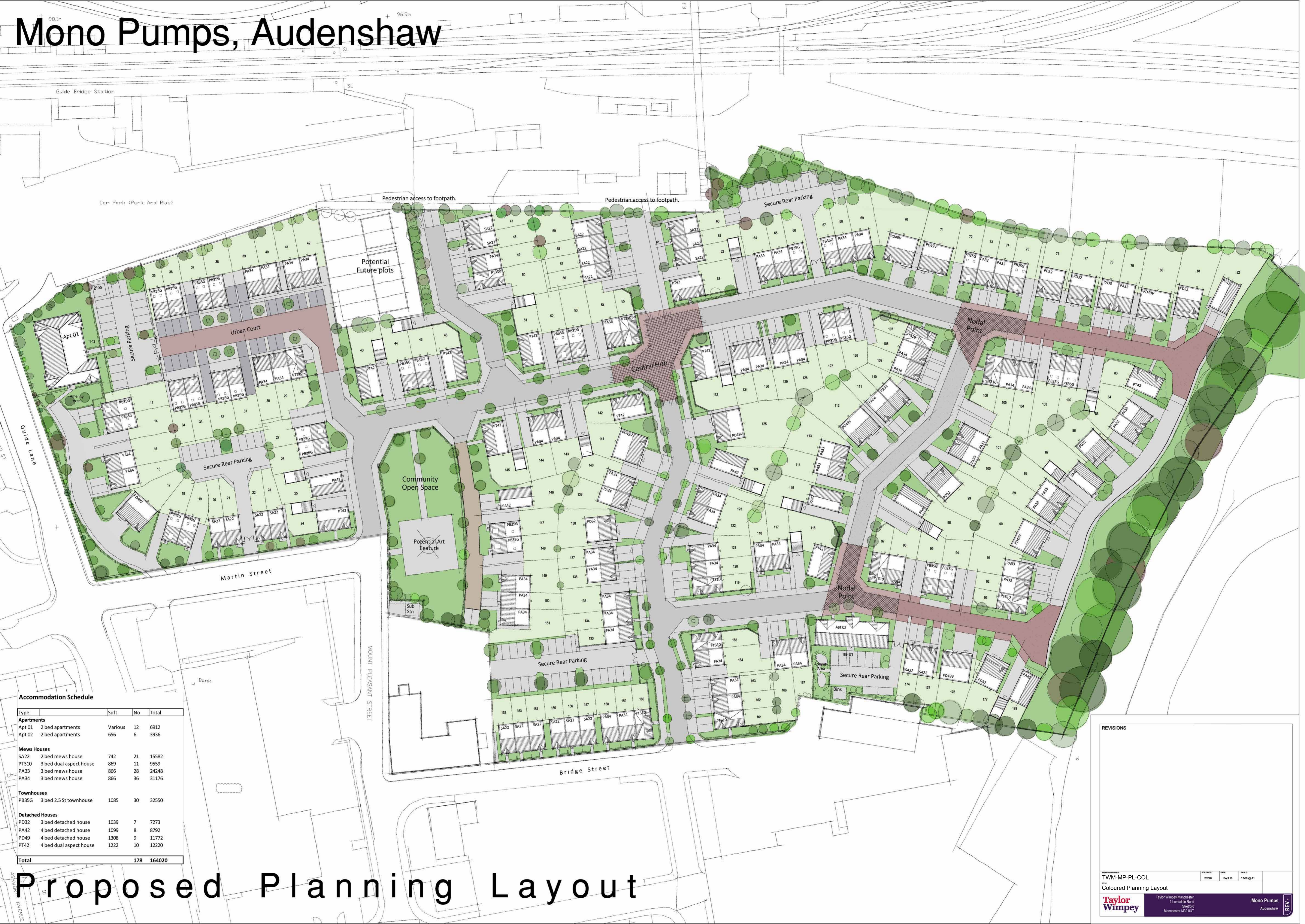

Accommodation Schedule

Type	Sqft	No	Total
Apartments			
Apt 01 2 bed apartments	Various	12	6912
Apt 02 2 bed apartments	656	6	3936
Mews Houses			
SA22 2 bed mews house	742	21	15582
PT310 3 bed dual aspect house	869	11	9559
PA33 3 bed mews house	866	28	24248
PA34 3 bed mews house	866	36	31176
Townhouses			
PB35G 3 bed 2.5 St townhouse	1085	30	32550
Detached Houses			
PD32 3 bed detached house	1039	7	7273
PA42 4 bed detached house	1099	8	8792
PD49 4 bed detached house	1308	9	11772
PT42 4 bed dual aspect house	1222	10	12220
Total		178	164020

Proposed Planning Layout

REVISIONS

NO	DATE	BY
1	2020	Sept 16

TWM-MP-PL-COL
Coloured Planning Layout

Taylor Wimpey
Taylor Wimpey Manchester
1 Lumley Road
Stretford
Manchester M32 0UT

Mono Pumps
Audenshaw

Mono Pumps, Audenshaw



Street Elevation A - Looking at the development from Martin Street



Street Elevation B - Looking at the development from Martin Street



Street Elevation C - Looking at plots 166 - 177

Proposed Street Elevations

REVISIONS
 Rev D - Updated and redrawn for November submission. Nov 16 1MS

TW/MKF-SE-01	15/11/2023	15/11/23	15/11/23	15/11/23
Proposed Street Elevations				
Taylor Wimpey	Taylor Wimpey	Taylor Wimpey	Taylor Wimpey	Taylor Wimpey
Architect	Architect	Architect	Architect	Architect